

RDP

RECIPROCATING TRIPLEX & QUINTUPLEX PLUNGER PUMPS

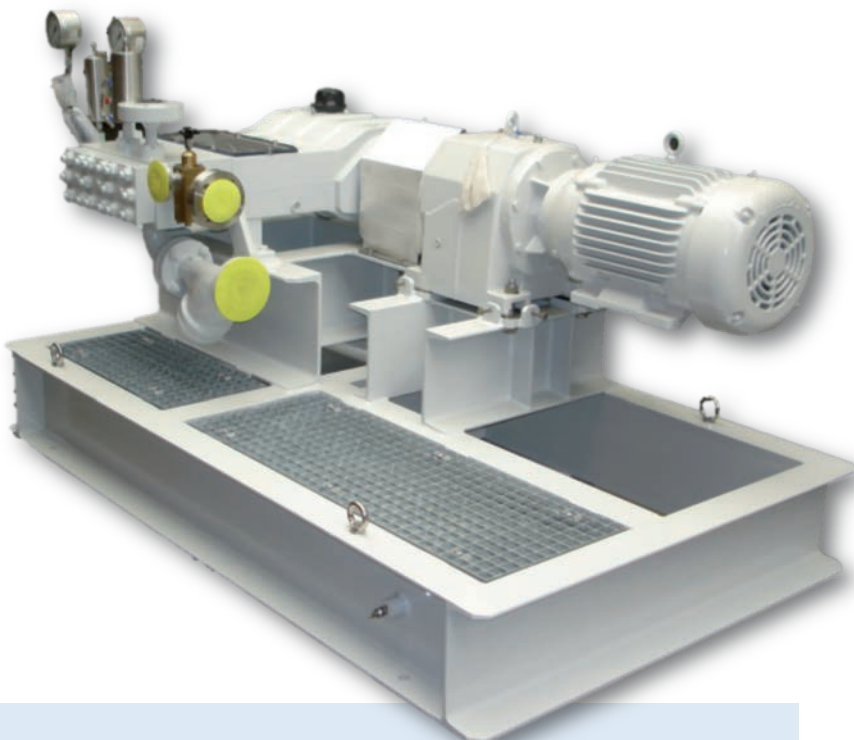

energy **API674**

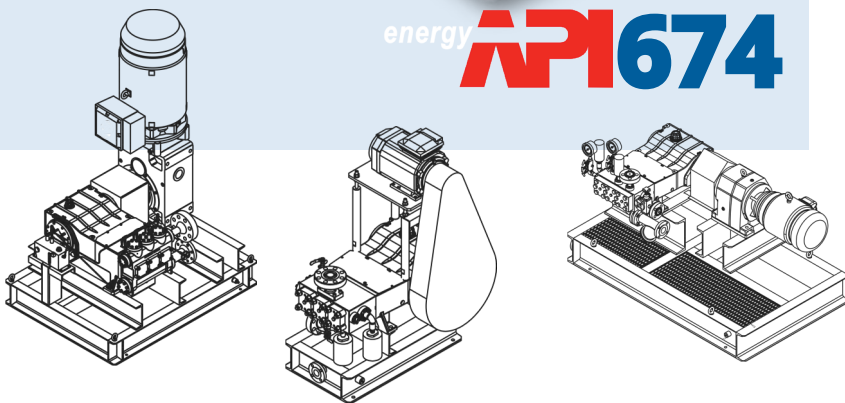

PERFORMANCE RANGE

Max Capacity	1611.0 gpm (366.5 m ³ /h)
Max Discharge Pressure	14500 psi (1000 bar)
Temperature	-104 °F to 392 °F (-40 °C to 200 °C)
Max Pump Speed	450 rpm (see note 3)
Pipe Size	1" to 8" (20 to 200 mm)

Notes:

1. For applications outside this range, please contact a Ruhrpumpen representative.
2. Max. Flow and Max. Pressure cannot be met at same time.
3. Maximum speed allowed by API674.

DESCRIPTION

The RDP series of Reciprocating Plunger Pumps is suitable for handling most liquids for Oil & Gas and Industrial applications.

- A variety of sizes are offered in Triplex and Quintuplex format.
- All are designed in accordance with API674 3rd edition and ISO13710.
- Easily accessible service points reducing maintenance time.
- Latest revised design for low noise and vibrational characteristics.
- High duty efficiency.
- Extensive range capability.
- Design life 20 years.

OPTIONAL FEATURES

- Can be manufactured to meet project specific specification such as Norsok, ASME, Russian CU TR, Statoil TR1655.
- Dampeners, PSV's and instrumentation can mount direct to Pump Head.
- Motor can mount direct to top of crankcase for compact offshore footprint.
- ATEX compliance for electrical and non-electrical machinery.
- Package condition monitoring
- Fugitive Emissions Seal Systems with condition monitoring.
- Various seal and power end lubrication options.
- Electric motor.
Diesel engine.
Hydraulic motor.
Variable speed drive.
- Various transmission options including:
Gearbox/V-belt drives.

APPLICATIONS

- Methanol injection
- Glycol circulation
- Reverse osmosis (seawater desalination)
- Water injection, production and jetting
- Hydrocarbon – Condensate
- Closed drain pumps
- Slops injection
- Boiler feed

CONSTRUCTION

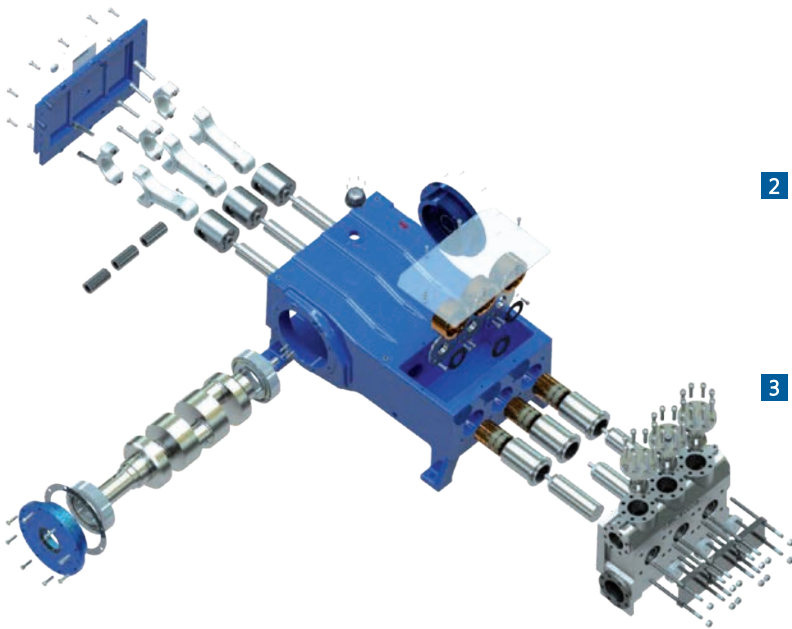

Images for illustration purposes not actual construction.

- 1 POWER END:** Robust design offering high mechanical efficiency and low noise emissions. Removable covers allow easy inspection and maintenance without removal of the pump. Standard builds feature splash lubrication, in addition, options can be added such as pressurised lubrication, heaters, coolers and condition monitoring to measure vibration and temperature.
- 2 FLUID HEAD:** Designed for high hydraulic efficiency and can be manufactured to meet project specific material requirements. Removable covers allow inspection and replacement of valves without disturbing pipework. Additional items can be added to the head such as PSV and dampeners.
- 3 STUFFING BOX:** Packing types available are braided or chevron type. Many different sealing plan options are available including 1 or 2 feed lubrication or flush arrangements. Easy to replace packing without having disturb pipework.

MATERIALS OF CONSTRUCTION

- Crankcase made in ductile iron with customer specific paint finish.
- Wetted parts can be made from a wide range of alloys incl NACE and Norsok compliance.
- All materials provided are high quality and NDT can be tailored to meet the project's requirements.

PERFORMANCE RANGE

